

BODY SPECIFICATIONS

| | 8yd ³ | 12yd ³ | 14yd ³ |
|---|------------------|-------------------|-------------------|
| Body Capacity | 8yd ³ | 12yd ³ | 14yd ³ |
| A. Body Length | 169" | 178" | 196" |
| B. Height Above Chassis Frame | 75" | 88" | 88" |
| C. Height Above Chassis Frame, Tail Gate Raised | 110" | 119" | 137" |
| D. Length Of Body, Tail Gate Raised | 205" | 236" | 250" |
| E. Width Of Body | 80" | 83" | 83" |
| F. Width Of Fenders | 85", 92", 96" | 85", 92", 96" | 85", 92", 96" |
| G. Loading Sill Height Above Chassis Frame | 21" | 21" | 21" |
| H. Loading Area Width | 31" | 31" | 31" |
| J. Top Of Hopper Opening Off Frame | 46" | 46" | 46" |
| Hopper Capacity | 4yd ³ | 4yd ³ | 4yd ³ |
| Practical Fillable Loading Volume | 1yd ³ | 1yd ³ | 1yd ³ |
| Body Weight | 5,100 LBS. | 6,400 LBS. | 6,480 LBS. |

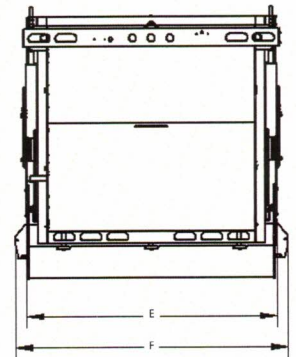
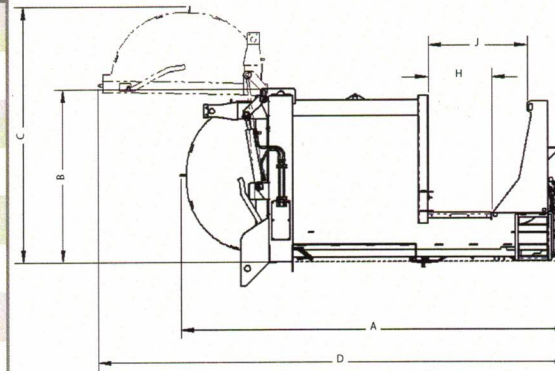

MINIMUM CHASSIS REQUIREMENTS

| | 8yd ³ | 12yd ³ | 14yd ³ |
|--|------------------|-------------------|-------------------|
| Minimum GVWR | 19,500 LBS. | 26,000 LBS. | 27,500 LBS. |
| Front Axle | 7,250 LBS. | 10,000 LBS. | 10,000 LBS. |
| Rear Axle | 13,650 LBS. | 16,000 LBS. | 17,500 LBS. |
| Cab to Axle | 102" | 120" | 120" |
| Required Frame Height | 30" TO 37.5" | 34" TO 37.5" | 34" TO 37.5" |
| Minimum Frame Rail Required (Back Of Cab) | 132" | 150" | 15" |

Features

- Chiseled Shell Design: Ultra-High Strength-to-Weight Ratio
- Low Loading Sill Height
- Ambidextrous Loading Sills
- One-Piece Formed Hardox Body Floor
- 14-16 Second Packing Cycle Times
- Standard 8" Side Doors
- No-Fallback Design
- Clean-Out Tray and Doors Both Sides

Body Construction

- Body Sides: 11 Gauge GR50
- Body Roof: 10 Gauge 80,000 PSI
- Body Floor: 3/16" Hardox
- Packer Face Panel: 3/8" 50,000 PSI

Hydraulic Cylinders

- All Cylinders Double Acting
- Pack (2) 3" Diameter
- TC8 – 2.5" Diameter Eject Cylinder
- TC12, TC14 – 3.5" Diameter Eject Cylinder
- Tailgate (2) 3" Diameter Cylinders

Hydraulic Tank

- Capacity: 12 Gallons
- Location: Upper Front
- Sight Gauge: On Tank
- Filter: 10 Micron Return Line Filter with By-Pass Valve

Pump

- Vane Type
- Capacity: 12 GPM @ 1,200 RPM
- Maximum Operation Pressure: 3,000 PSI

Optional Equipment

- Strobe Lights & Work Lights
- Cart Tippers
- Hopper Cover
- Upper Hopper Doors
- Split Body (Available in 8yd³, 12yd³, 14yd³)